

New modular
feeder types

SCK

FEEDING SYSTEM

SLEEVE CONSTRUCTION KIT



Advantages

The new feeder system offers many advantages

- + Components can be tailored to the required modulus and volume
 - + Lower inventory required to cover the variety of shapes needed
 - + The Feed safety margin or volume can be increased for critical sections
- + Smallest possible foot print area and lowest fettling
 - + Reduced costs
 - + Fewer cracks in crack-sensitive alloys
- + Simple assembly of different components by locators
 - + Low weight for better workplace ergonomics
- + Good sand compaction in the area of the feeder neck
- + Integrated Williams wedge for directional solidification
- + Constant volume
- + Wide range of products



Modular feeding system

for Jobbing Iron

The system consists of:

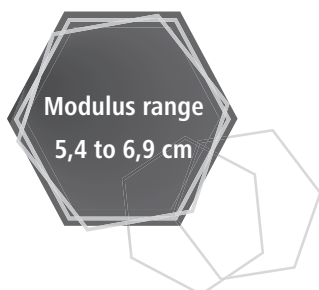
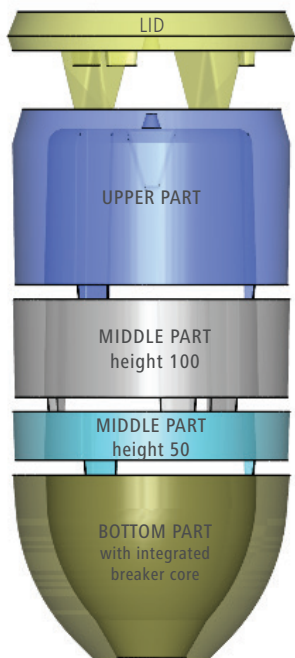

System in application:



Modulus [cm]

5,4

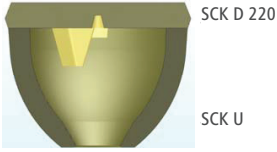

5,8

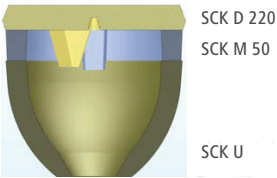

6,0

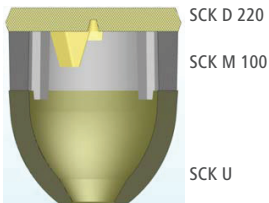

6,3

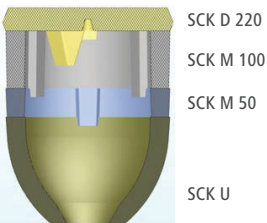

6,5

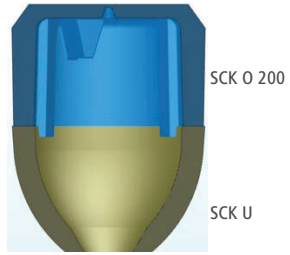

6,7

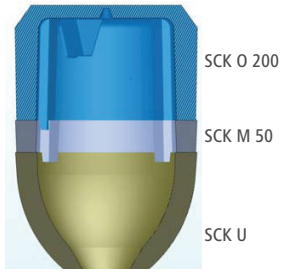

6,8

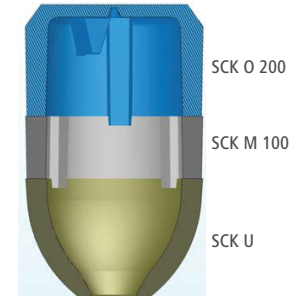

6,9

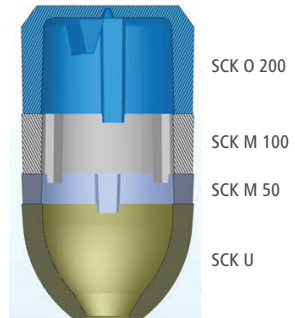

Order matrix

Modulus [cm]	Vol. [dm ³]	Bottom part C6 SCK U		Middle part HD1 SCK M		Upper part HD1 SCK O 200	Lid HD1 SCK D 220
		Neck aperture		Hight			
		40	70	50	100		
5,4	4,4	x	x				x
5,8	6,2	x	x	x			x
6,0	8,0	x	x		x		x
6,3	9,8	x	x	x	x		x
6,5	9,7	x	x			x	
6,7	11,5	x	x	x		x	
6,8	13,3	x	x		x	x	
6,9	15,1	x	x	x	x	x	

Bottom part for steel D=110

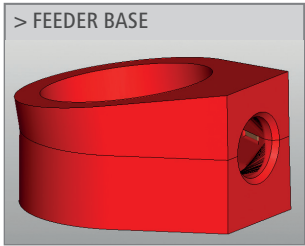
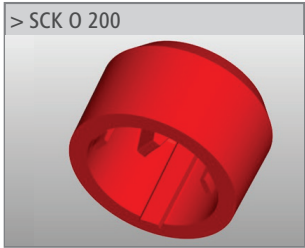
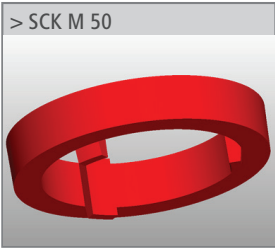
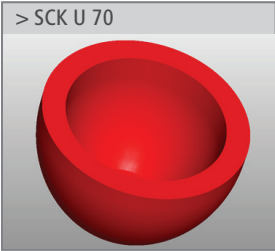



FOSECO

Contact

Do you have further questions regarding the new feeding system?

Please contact your local Foseco Company

Foseco International Ltd.
www.foseco.com